



ICEU106

### Features and Benefits

- Produces clear, long-lasting shot-style cubes.
- Space-saving 467 mm wide undercounter design.
- Produces up to 50 kg of ice per day.
- Built-in storage bin stores up to 22 kg.
- Constructed from sturdy, corrosion-resistant stainless steel and fingerprint-proof plastic.
- Ideal for any undercounter or bar application.
- Contemporary, elegant design.

ICEU106 SELF CONTAINED MACHINE

### Options & Accessories

Ice Machine Model	WATER FILTERS		
	Manifold		Inline
	System	Replacement	System
ICEU106	IFQ1	IOMQ(1)	IF14C / IF18C

### Ice Maker Warranty

Every Ice-O-Matic ice maker is backed by a warranty that provides both parts and labor coverage.

- Two years Parts
- One year Labor

### Ice Form



### BISTROT CUBE

SHOT STYLE	
Height (mm)	30.5
Diameter (mm)	29.5



ICEU106 SELF CONTAINED MACHINE

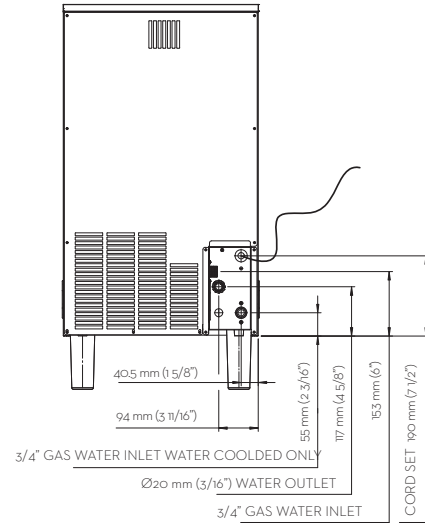
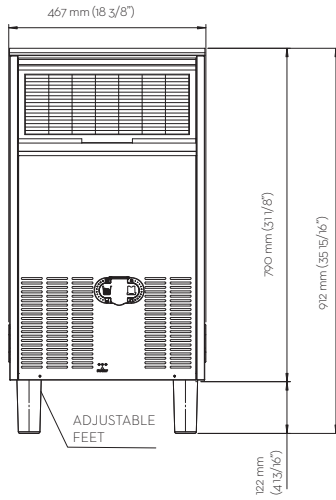
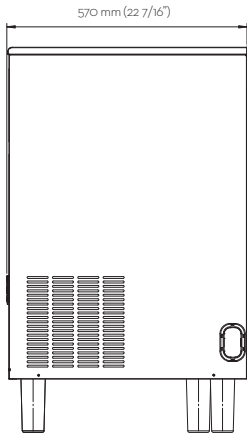

## Operating Requirements

	MINIMUM	MAXIMUM
	<b>50 Hz</b>	
Ambient Temp. Range Air	10°C	43°C
Water Temp.	5°C	38°C
Water Pressure	0.8 BAR	5 BAR
Electrical Voltage	230V/50Hz/1ph	

## Dimensions

ALL MODELS		
without legs	W x D x H (mm)	467 x 570 x 790
	W x D x H (in.)	18 x 22 x 36

## Specifications

Model Number	Cond. Unit	Ice Production per 24 hrs 10°C air/ 10°C water (kg)	Storage Capacity (kg)	Water Consumption (Lt/60)	Electric Consumption (kWh/24hr)	Voltage Characteristics
ICEU106AS	Air	46	22	5,8	9,9	230/50/1
ICEU106WS	Water	50	22	60,6	8,5	230/50/1

NOTES:  
 Approx. Shipping Weight kg (lbs): 44 (97)  
 Refrigerant Type: R404A  
 All specifications and performance data are subject to normal manufacturing variances.